

Sam Brooks

Interior Design
United Kingdom

View the full portfolio at <http://www.thecreativefinder.com/brooksbydesign>

Professional Experience and Curriculum Vitae

I recently achieved a distinction for my Masters Degree in Interior Design, having previously studied furniture and product design at degree level.

I am now looking to put this into practice by gaining some professional experience within a multidisciplinary practice.

My recent work has been highly experimental in nature but led to sound practical solutions.

This work has explored the idea of using soundscapes to develop site analysis, which provides a unique perspective on ones surroundings.
Or the study of dark interior space and how it can influence our ability to perceive our environment and enrich our understanding of it.

Previous Clientele

Please kindly get in touch for more information.

Awards and Accolades

SAMUEL BROOKS

www.brooksbydesign.wordpress.com

brooksbydesign@gmail.com

Design Skills

Interior
Furniture
Product
Graphic

Software Skills

AutoCAD
SketchUP
Microsoft Office
Adobe Photoshop
Adobe InDesign
Quark Express

Work Experience

Produced inside cover image for professor Zeynep Aygen's book titled, 'International Heritage and Historic Building Conservation,' to be published November 2012 by Routledge.

Manager at the King Alfred Pub Winchester, 2007-2011
130 Lloyd Road Singapore 239098 (co. reg. 201004398N)

Education
helpdesk 656.227.2902, fax 656.227.0213

WWW.THECREATIVEFINDER.COM Interior Design, University of Portsmouth, 2011 to 2012

Buckinghamshire New University 2004 to 2007

BA Contemporary furniture and related product design: upper-second with honours (2:1)

Sam Brooks

Interior Design
United Kingdom

View the full portfolio at <http://www.thecreativefinder.com/brooksbydesign>



Like many other products, furniture is becoming increasingly disposable in contemporary society. The need to highlight the value of repairing rather than discarding is increasingly important. By using a process that we associate with healing ourselves, I looked to create a range of furniture that had a sense of the uncanny to them and thus inspire thought about what they are. By testing materials and processes rather than specifically designing, I was able to discover that Kholi fix was the perfect material for attaching broken furniture together as it not only had a direct link to our memories of broken bones but also supported the furniture structurally with a distinct aesthetic style.

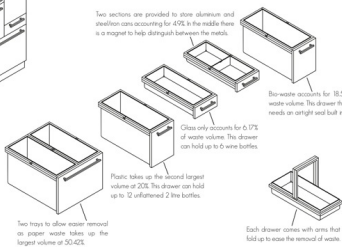

The 100kg load-bearing ones are 100% extendable allowing drawers to be fitted straight out easily.



With the growing demand for green solutions in everyday living, people are having to realise that recycling within their homes is a necessity. Kitchens being the main area of waste production and disposal make installing a waste management unit here ideal. By making each drawer from material specific such as bio-waste, wooden and metal, it's simple to identify the correct drawer while also creating an attractive appearance.

Sam Brooks

Interior Design
United Kingdom

View the full portfolio at <http://www.thecreativefinder.com/brooksbydesign>

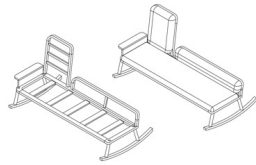
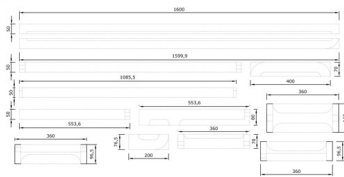
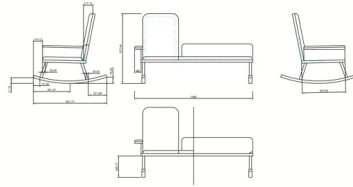

The Negotiated project brief takes an item of furniture from the past and updates its relevance to the current. I chose a unique piece of furniture that was half rocking chair and half baby cot. To put a new spin on it I adapted the use from cot to couples, developing the idea of how couples relax together on a sofa or in front of a warm fireplace. Due to the more complex nature of a rocking item of furniture extensive drawings and models were required to fully realise a working rocking motion.



The 'Donkey' is an iconic product from the furniture company Isokon. This re-invention of the donkey was designed to make the reading of books a little more enjoyable. The simple structure of the donkey means that only five components are needed and once assembled they interlock to create storage space and structural support.

Sam Brooks

Interior Design
United Kingdom

View the full portfolio at <http://www.thecreativefinder.com/brooksbydesign>

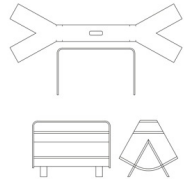
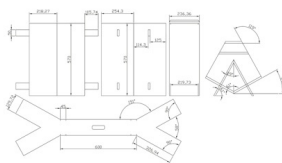
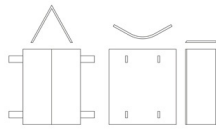
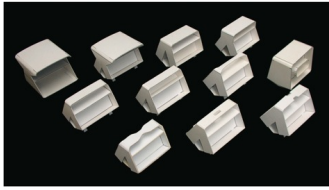

The process of development was greatly enhanced by the use of 1:5 scale models that help one to realise the 3 dimensional form as well as gain a true understanding of the donkeys proportions. Using AutoCAD I was able to draft the five components that make up the donkey. A key aspect of the finished donkey is the use of moulded plywood to create the curves on the top and bottom section. This process uses a mould and jig that allows the exact replication of components.

Welcome to Mottisfont

Soundscape of the Past and Present

The landscape of the past and present is a complex one. It is a landscape that has been shaped by centuries of human activity. The soundscape of the past is a mix of natural sounds and human-made sounds. The soundscape of the present is a mix of natural sounds and human-made sounds.

Conservation of Mottisfont Abbey

A key element of the project was the conservation of Mottisfont Abbey. The abbey is a Grade I listed building and is a Scheduled Ancient Monument. It is a place of great historical and architectural interest. The project aimed to restore the abbey to its former glory while preserving its historical significance.

the big 1941.

The big image shows the interior of the gallery. It is a large, open-plan space with high ceilings and large windows. The gallery is designed to be a place of quiet reflection and contemplation. It is a place where visitors can appreciate the art and architecture of the past.

A Photo of Thomas Lawrence in 1810.

The image shows the interior of the gallery. It is a large, open-plan space with high ceilings and large windows. The gallery is designed to be a place of quiet reflection and contemplation. It is a place where visitors can appreciate the art and architecture of the past.

The design links interior and exterior space through soundscapes of the present and narratives from the past.

Sam Brooks

Interior Design
United Kingdom

View the full portfolio at <http://www.thecreativefinder.com/brooksbydesign>

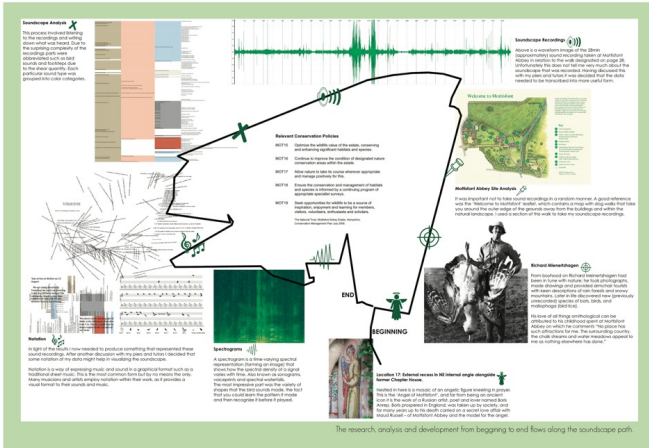

Sam Brooks

Interior Design
United Kingdom

View the full portfolio at <http://www.thecreativefinder.com/brooksbydesign>

