

# Sam Brooks

Interior Design  
United Kingdom

View the full portfolio at <http://www.thecreativefinder.com/brooksbydesign>

## Professional Experience and Curriculum Vitae

I recently achieved a distinction for my Masters Degree in Interior Design, having previously studied furniture and product design at degree level.

I am now looking to put this into practice by gaining some professional experience within a multidisciplinary practice.

My recent work has been highly experimental in nature but led to sound practical solutions.

This work has explored the idea of using soundscapes to develop site analysis, which provides a unique perspective on ones surroundings.  
Or the study of dark interior space and how it can influence our ability to perceive our environment and enrich our understanding of it.

## Previous Clientele

Please kindly get in touch for more information.

## Awards and Accolades

SAMUEL BROOKS

[www.brooksbydesign.wordpress.com](http://www.brooksbydesign.wordpress.com)  
[brooksbydesign@gmail.com](mailto:brooksbydesign@gmail.com)

## Design Skills

Interior  
Furniture  
Product  
Graphic

## Software Skills

AutoCAD  
SketchUP  
Microsoft Office  
Adobe Photoshop  
Adobe InDesign  
Quark Express

## Work Experience

Produced inside cover image for professor Zeynep Aygen's book titled, 'International Heritage and Historic Building Conservation,' to be published November 2012 by Routledge.

Manager at the King Alfred Pub Winchester 2007-2011  
130 Lloyd Road Singapore 239098 (co. reg. 201004398N)  
helpdesk 656.227.2902, fax 656.227.0213

## Education

MA in Interior Design, University of Portsmouth, 2011 to 2012

Buckinghamshire New University 2004 to 2007

BA Contemporary furniture and related product design: upper-second with honours (2:1)

# Sam Brooks

Interior Design  
United Kingdom

View the full portfolio at <http://www.thecreativefinder.com/brooksbydesign>



Like many other products, furniture is becoming increasingly disposable in contemporary society. The need to highlight the value of repairing rather than discarding is increasingly important. By using a process that we associate with healing ourselves, I looked to create a range of furniture that had a sense of the uncanny to them and thus inspire thought about what they are. By testing materials and processes rather than specifically designing, I was able to discover that Wood Resin was the perfect material for attaching broken furniture together as it not only had a direct link to the memories of broken bones but also supported the furniture structurally with a distinct aesthetic style.

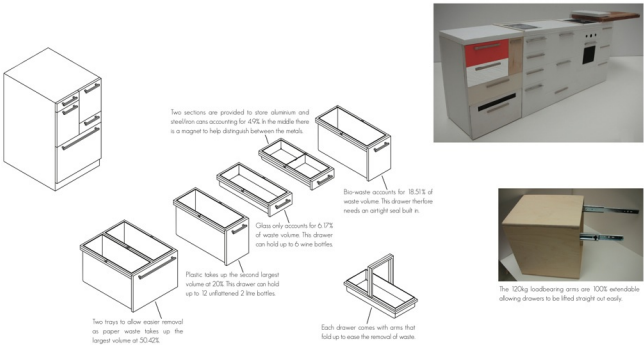

Two sections are provided to store aluminium and stainless steel accounting for 47% of the waste. There is a magnet to help distinguish between the metals.



Biowaste accounts for 18.5% of waste volume. This drawer therefore needs an airtight seal built in.

Glass only accounts for 6.1% of waste volume. This drawer can hold up to 6 wine bottles.

Plastic takes up the second largest volume at 20%. This drawer can hold up to 12 unflattened 2 litre bottles.

Two trays to allow easier removal of paper waste takes up the largest volume at 30.4%.

Each drawer comes with arms that fold up to ease the removal of waste.



The 100kg loadbearing arms are 100% extendable allowing drawers to be filled straight out easily.



With the growing demand for green solutions in everyday living, people are having to realise that recycling within their homes is a necessity. Kitchens being the main areas of waste production and disposal make installing a waste management unit here ideal. By making each drawer front material specific such as bio-waste wooden and metal metallic it is simple to identify the correct drawer while also creating an attractive appearance.

# Sam Brooks

Interior Design  
United Kingdom

View the full portfolio at <http://www.thecreativefinder.com/brooksbydesign>

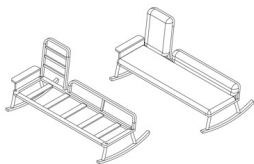
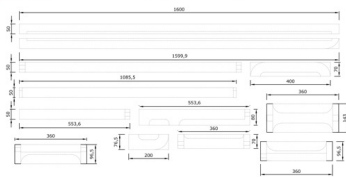
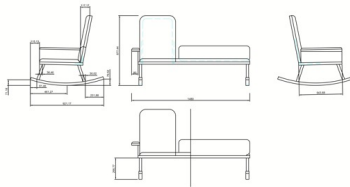

The Negated project brief takes on item of furniture from the past and updates its relevance to the current. I chose a unique piece of furniture that was half rocking chair and half baby cot. To put a new spin on it I adapted the use from cot to couples, developing the idea of how couples relax together on a sofa or in front of a warm fireplace. Due to the more complex nature of a rocking item of furniture extensive drawings and models were required to fully realise a working rocking motion.



The 'Donkey' is an iconic product from the furniture company Isokon. This re-invention of the donkey was designed to make the reading of books a little more enjoyable. The simple structure of the donkey means that only five components are needed and once assembled they interlock to create storage space and structural support.

# Sam Brooks

Interior Design  
United Kingdom

View the full portfolio at <http://www.thecreativefinder.com/brooksbydesign>

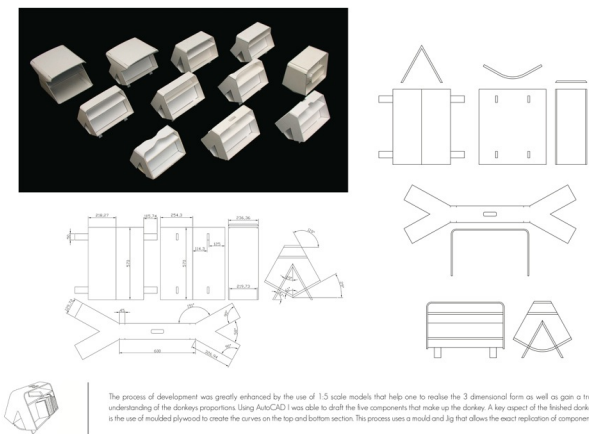

The process of development was greatly enhanced by the use of 1:5 scale models that help one to realise the 3 dimensional form as well as gain a true understanding of the donkeys proportions. Using AutoCAD I was able to draft the five components that make up the donkey. A key aspect of the finished donkey is the use of moulded plywood to create the curves on the top and bottom section. This process uses a mould and jig that allows the exact replication of components.

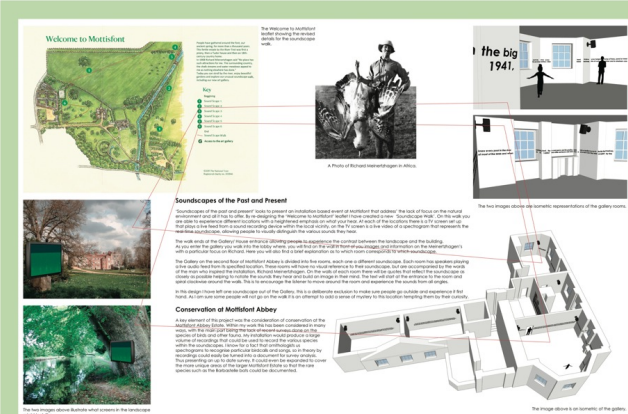

The design links interior and exterior space through soundscapes of the present and narratives from the past.

## Interior Design United Kingdom

View the full portfolio at <http://www.thecreativefinder.com/brooksbydesign>

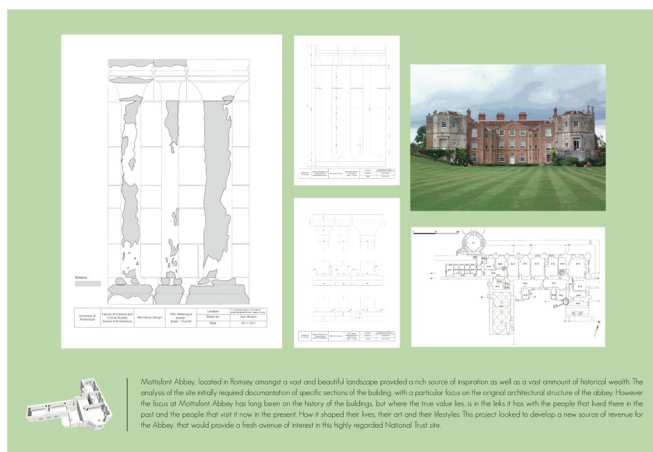
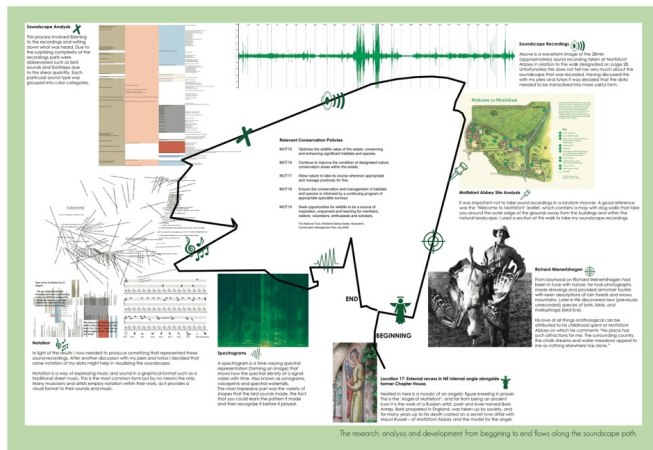

# Sam Brooks

Interior Design  
United Kingdom

View the full portfolio at <http://www.thecreativefinder.com/brooksbydesign>

